



# 2013 *Commencement*

.....

KEENE STATE COLLEGE

MAY 11, 2013 ♦ FISKE QUAD

---

Welcome to  
*Commencement 2013*

.....



.....

May 11, 2013 ♦ Fiske Quad

**Keene State College**  
Keene, New Hampshire

---



CHAD CASSIN

## Keene State College

---

Founded in 1909 with 27 students as a two-year normal school to train teachers for rural classrooms, the school expanded into four-year programs in 1939, when it was named Keene Teachers College. Graduate studies were introduced after World War II, and in 1963 the institution became Keene State College, part of the University System of New Hampshire and authorized by the legislature to provide curricula in the liberal arts and sciences. Today the College has more than 5,700 students on its 170-acre campus and offers nearly 40 programs of study.

As a public liberal arts college, Keene State is distinguished by an academic program designed to develop the habits of mind – critical reading, precise writing, creative thinking – that prepare students for professional work and good citizenship. The school provides a wealth of opportunities for collaboration among students, faculty, and community partners. Students who walk down Appian Way for the first time find small classes, personal attention from superb faculty, experiential learning, an appreciation of diversity, and a sense of community that values the whole person. Supportive residential life programs, the chance to study abroad, and the excitement and challenge of championship Division III athletics round out the Keene State experience. The motto “Enter to learn, go forth to serve” engraved on the Appian Gateway becomes a touchstone in the lives of graduates.

---

---

COMMENCEMENT 2013

---

PROCESSIONAL	Brass Ensemble <i>Assistant Professor James Chesebrough, Conductor</i>
MACE	Carl Granquist <i>Professor of History</i>
WELCOME	Jay Kahn <i>Interim President</i>
NATIONAL ANTHEM	Cady Lavoie '13 <i>Bachelor of Science</i> Brass Ensemble
SENIOR CLASS REMARKS	Alison Hammell <i>President, Senior Class</i>
PARENTS ASSOCIATION GREETINGS	Lynn Rice Scozzafava <i>President, KSC Parents Association</i>
GREETINGS FROM THE UNIVERSITY SYSTEM	Richard E. Galway <i>Chair, Board of Trustees</i> <i>University System of New Hampshire</i>
COMMENCEMENT ADDRESS	Jeanne Shaheen <i>U.S. Senator for New Hampshire</i>
GRANITE STATE AWARD	Interim President Kahn
ACKNOWLEDGMENT OF GRANITE STATE AWARD	Margaret Ramsay '56 M'64
AWARDING OF HONORARY DEGREE	Interim President Kahn
ACKNOWLEDGMENT OF HONORARY DEGREE	Fernand Prevost '57
CONFERRING OF DEGREES	Melinda D. Treadwell <i>Provost and Vice President for Academic Affairs</i>  Andrew Harris <i>Dean, School of Arts and Humanities</i>  Gordon Leversee <i>Dean, School of Sciences and Social Sciences</i>  Wayne Hartz <i>Dean, School of Professional and Graduate Studies</i>
WELCOME INTO ALUMNI ASSOCIATION	Linda Lacey '73 <i>President, KSC Alumni Association</i>
CLOSING REMARKS	Interim President Kahn
SINGING OF THE ALMA MATER	David Parker '13 <i>Bachelor of Music</i>
RECESSIONAL	Brass Ensemble

---



## *Lift Voices High*

The Keene State College Alma Mater

On lilac paths we've strolled, past halls in ivy twined,  
'Neath Mount Monadnock rising bold,  
Our college stands enshrined.

A toast to Keene, to days gone by,  
For days to come, lift voices high and sing.

For Keene State College stands, throughout the mist of time,  
Yet strong she spreads her knowledge grand, eternally benign.

A toast to Keene, to days gone by,  
For days to come, lift voices high and sing.



Words by Katherine Day Bourne '60, Patricia Piper Bushey '59,  
and Judith Palmer Marshall '59

Music by Ann Weeks Pearson '59

Arranged by Professor William D. Pardus (1991)

## Class of 2013

**President** Alison Hammell

**Vice President** Kaleigh Liupakka

**Secretary** Kassandra Tenney

**Treasurer** Natalie Savas

### Class Representatives

Kristen Rankin

Chelsea Clouse

### Class Advisor

Mandy Martin

### Marshals

#### Junior Class Officers

**President** Aaron Testa

**Vice President** Lindsay Shapiro

**Secretary** Sarah Kelley

**Treasurer** Erin Donnelly

#### Junior Class Representative

Haley McConville

### Gonfalon Carriers

**Professional & Graduate Studies** Peter Hartz

**Arts & Humanities** Matthew Parkes

**Sciences & Social Sciences** Deena Snoko

### Ushers

KSC Alumni, Student Center Summer Staff

---

*Graduates, faculty, staff, and families are invited to the President's Reception at the Zorn Dining Commons and plaza following the Commencement Ceremony.*

*Restrooms are located in Morrison Hall, Parker Hall, Rhodes Hall, Zorn Dining Commons, and L. P. Young Student Center.*

*The Keene State College campus is a tobacco-free zone Saturday, May 11, 2013.*

---



## Jeanne Shaheen

### *Commencement Address*

Jeanne Shaheen is the first woman to be elected Governor of New Hampshire, the first woman in history to have been elected both a Governor and a United States Senator, and the first woman from New Hampshire to be elected to the U.S. Senate. She has served in the United States Senate since 2009, is a member of the Senate Committees on Armed Services, Foreign Relations, Appropriations, and Small Business and Entrepreneurship, and is the dean of the New Hampshire congressional delegation.

Although neither of Senator Shaheen's parents graduated from college, her father worked his way up to a management position in the shoe manufacturing business and her mother worked as a secretary in their local church. After attending public schools, Senator Shaheen received a bachelor's degree from Shippensburg University in Pennsylvania and a master's degree from the University of Mississippi. She taught high school in Mississippi and moved to New Hampshire in 1973, where she taught school and owned a small business.

Senator Shaheen has been involved in all levels of New Hampshire life. She was chair of Madbury's zoning board and co-chair of the New Hampshire Commission on the Status of Women. She was the co-founder of Somersworth's International Children's Festival and director of two successful New Hampshire presidential primary campaigns.

Senator Shaheen served as Governor of New Hampshire from 1997 to 2003. During her three terms, she balanced the state's budget each year.

As Governor, she led trade missions to England, Ireland, Northern Ireland, Germany, Denmark, Mexico, and Canada. As an election monitor for the National Democratic Institute, she has monitored elections in Nigeria, Armenia, and the Middle East.

She has demonstrated an ongoing commitment to education. She helped make college more affordable through a tax-free college tuition savings plan, the Granite State Scholars program, and greater state support for public universities and community colleges. Her kindergarten initiative has made public kindergarten a reality for over 25,000 additional children and the innovative children's health insurance program she launched has extended affordable health coverage to tens of thousands of New Hampshire children.

Between her time as Governor and election to the U.S. Senate, she served as the director of Harvard University's Institute of Politics at the Kennedy School of Government, inspiring a new generation of political leaders to bring both education and ethics to their careers.

---



## Margaret Russell Ramsay '56 M'64

### *Granite State Award*

Keene State College today honors Margaret Russell Ramsay '56 M'64, who has been a dedicated volunteer in service of Keene State College and the State of New Hampshire, serving in many capacities over many years.

Her willingness to stand up for what she believes, and to advocate for Keene State College on multiple fronts, is unequalled. The thousands of hours of hard work she has put into making the College, and the state, a better place have also served as an amazing testament to this institution.

Ms. Ramsay began her professional life as a teacher, teaching in Marlborough and Keene.

She was elected to the KSC Alumni Board of Directors in 1969, and served as that body's president from 1970-72. During her tenure, Ms. Ramsay worked to complete the renovation of the College Camp on Wilson Pond. She also represented Keene State Alumni on the USNH Board of Trustees for eight years, beginning in 1970.

From 1976 until 1988, she served as the Swanzey representative to the New Hampshire House of Representatives, serving on the Arts and Education Committee, among many others, during which time she worked to collect support and funding for the Redfern Arts Center on Brickyard Pond.

In 1983, Ms. Ramsay received the Sprague W. Drenan Award, given annually to alumni for their participation in and support of alumni activities.

In 1984, she was one of only 75 recipients of the College's Jubilee Medallion, awarded to those who had contributed to Keene State's success in its first 75 years.

In 1988, Ms. Ramsay returned to Keene State for a decade, serving students first as the continuing education coordinator and later in the office of Advancement and Alumni Affairs.

She was a member of the Board of Trustees of the Keene Endowment Association beginning in 1972 and was the Association's president from 1990-2004, managing the independent charitable entity in its mission of providing assistance to deserving students at Keene State.

For decades of seemingly tireless service to New Hampshire and to Keene State College, we are pleased to present her with the Granite State Award.

---



## Fernand Prevost '57

### *Honorary Doctor of Science degree*

Keene State College today honors Fernand Prevost '57 for his contributions to mathematics education over 50 years on regional, state, and national stages, as well as for his service to the College as an alumnus.

Dr. Prevost served for 30 years as the New Hampshire State Mathematics Consultant. In this role, he touched the lives of countless mathematics teachers and students at all grade levels.

He often presented workshops for teachers with a vision of making New Hampshire mathematics classrooms vibrant and dynamic learning centers.

Fifty years ago, Dr. Prevost and mathematics education colleagues established the New Hampshire Teachers of Mathematics Association (NHTM). In 1994, NHTM recognized him for his service to the profession by creating the Fernand J. Prevost Mathematics Teaching Award. This award is given annually to a New Hampshire mathematics teacher in her/his first, second, or third year who meets criteria based on characteristics that Dr. Prevost exemplified in his own teaching.

Dr. Prevost has also contributed to mathematics education on a national level via his work with the National Council of Teachers of Mathematics (NCTM) and with the Association of State Supervisors of Mathematics (ASSM). Not only has he been an invited speaker at numerous regional and national meetings of NCTM and ASSM over the years, he has served on innumerable committees of both organizations, always lending his support to those in national leadership positions.

In 2007, the Mathematics Departments of the University System of New Hampshire (KSC, PSU, UNH-Durham, and UNH-Manchester) came together to honor him for his outstanding contributions to mathematics education. He also received the Granite State Award from what was then Plymouth State College in 1985.

Dr. Prevost cites his education at Keene State College as a foundation for his success in teaching. In the 56 years since his graduation, he has brought great recognition not only to the discipline of mathematics education but also to Keene State. He is highly respected by generations of Keene State educators, and is seen as a leader among them.

He and his wife, Myrna '58, have also been involved alumni, attending hundreds of alumni programs over the years. Dr. Prevost exudes pride in Keene State and reinforces that pride in other alumni.

For his achievement in his field and his contributions to mathematics education in New Hampshire and far beyond, we are pleased to award him the honorary Doctor of Science degree.

---



MICHAEL MOORE

## Honorary Distinctions

Summa Cum Laude	Cumulative Grade Point Average of 3.90 to 4.00
Magna Cum Laude	Cumulative Grade Point Average of 3.70 to 3.89
Cum Laude	Cumulative Grade Point Average of 3.50 to 3.69

Honor Society	Discipline	Cord Color
Beta Beta Beta	Biology	Red and green
Lambda Pi Eta	Communication	Red and gold
Upsilon Pi Epsilon	Computer Science	Maroon and white
Omicron Delta Epsilon	Economics	Gold and blue
Kappa Delta Pi	Education	Purple and green
Sigma Tau Delta	English	Black and red
Pi Delta Phi	French	Red, white, and blue
Gamma Theta Upsilon	Geography	Blue, gold, and brown
Order of Omega	Greek Leadership	Gold and ivory
Eta Sigma Gamma	Health Science	Green and gold
Phi Alpha Theta	History	Red and blue
Zeta Chi Rho	Holocaust and Genocide Studies	Black and burgundy
Delta Mu Delta	Management	Purple and gold
Kappa Mu Epsilon	Mathematics	Pink and silver
NSCS	National Society of Collegiate Scholars	Maroon and gold
Phi Epsilon Kappa	Physical Education	Black and gold
Psi Chi	Psychology	Blue and silver
Rho Kappa Sigma	Safety Studies	Green and gold
Alpha Kappa Delta	Sociology	Teal
Sigma Delta Pi	Spanish	Red and gold
Alpha Psi Omega	Theatre and Dance	Midnight blue and amber gold
Who's Who Among Students in American Universities & Colleges		Blue and gold

The following list of names includes those candidates who earned degrees from Keene State College in September and December of 2012, those who have shown evidence of completion of degree requirements as of May 3, 2013, and those who anticipate completion of requirements by September or December 2013. Academic honors are based on information available through the completion of the fall 2012 semester. The Office of the Registrar at Keene State College maintains the official graduation and honors lists and issues diplomas verifying the completion of degree programs in accordance with the policies of the College. The following list reflects information submitted to the Office of the Registrar as of April 1, 2013.

## Arts and Humanities

Jason Sanford Abisch, BA\*  
Thomas Scott Adams, BA  
*Nat Soc Collegiate Scholar*

Paige Alyson Agrella, BA  
*Magna Cum Laude*  
*Lambda Pi Eta*

Stacey A. Aleksa, BA  
Harold Eugene Amberg, BA  
Nicole Lindsay Anderson, BA

*Magna Cum Laude*  
*Lambda Pi Eta*  
*Nat Soc Collegiate Scholar*

Lindsey Victoria Arceci, BA  
Michael James Leo Aucoin, BFA  
Casey Burton August, BA

Hillary Jean Bailey, BA  
*Cum Laude*  
Alexander Michael Baker, BFA

*Magna Cum Laude*  
Haley Perry Bannon, BA  
Mandy Monroe Baril, BA\*\*

Jamie Alexandra Barker, BA  
Garrett James Beltis, BA  
Dillon Andrew Benik, BA

*Magna Cum Laude*  
Andrew Carleton Benson, BA  
Rachel Kathryn Benson, BA

*Magna Cum Laude*  
Michelle D. Berthiaume, BA  
Brittany E. Bianchi, BFA\*

Kalin Elizabeth Billert, BA  
*Cum Laude*  
*Lambda Pi Eta*

Diana Marie Bishop, BA  
Megan Michelle Blanchette, BFA  
Katie Ann Bolvin, BA

Sean David Bowes, BFA  
*Cum Laude*  
Bret David Bradley, BA\*

Taylor S. Brodersen, BA  
Holly Catherine Brown, BA  
Colleen Elizabeth Butler, BA

*Lambda Pi Eta*  
Rachele Aline Caliguri, BA\*\*  
James Franklin Caltrider II, BM\*

*Cum Laude*  
Lauren E. Campbell, BA  
Scott Campbell, BA

Rachel Ann Carmine, BA  
Brandon William Carta, BA  
*Upsilon Zeta*

*Nat Soc Collegiate Scholar*  
Paige Nicole Carusello, BA  
*Cum Laude*

Alison Nicole Cederbaum, BA  
*Magna Cum Laude*  
*Lambda Pi Eta*

*Nat Soc Collegiate Scholar*  
Sonya Kimberly Cheney, BA  
Melissa Kate Childs, BA

Danielle Providencia Clark, BA  
*Cum Laude*  
*Nat Soc Collegiate Scholar*

Lamar Teshan Clark, BA  
Seth Spencer Clason, BA  
Jennifer Larissa Close, BA

Margaret Catherine Colby, BA  
*Cum Laude*  
Jessica Robin Collin, BFA

John William Collins, BA  
Jessica Taylor Colon, BA  
*Cum Laude*

*Kappa Delta Pi*  
Alyssa Ann Comeau, BM  
*Magna Cum Laude*

*Nat Soc Collegiate Scholar*  
Mary Honora Connolly, BFA  
Kali Z. Consigli, BA

Emory Miller Cooper, BFA  
Maxwell Robert Cooper, BA  
Travis Michael Corcoran, BA, BM

Bradford Paul Cormier, BA  
Jonathan Manuel Correia, BA  
Kayleigh Muriel Corrigan, BA

Samantha Lynn Cressotti, BA  
Christopher James Cronin, BA  
Whitney Elizabeth Ruth Cyr, BA

*Magna Cum Laude*  
*Keene State Honors Program*  
Emily T. Davidson-Toman, BA\*\*

\* Expected to meet graduation requirements in September 2013

\*\* Expected to meet graduation requirements in December 2013

---

COMMENCEMENT 2013

---

Victoria Kathrin Davis, BA\*

Michelle Marie Davy, BA

*Cum Laude*

Samantha Rose Day, BA\*\*

Jonathan F. DeBenedict, BA

Kaley Elizabeth DeBoer, BA

Jaime Lynn Del Pizzo, BA

*Cum Laude*

*Lambda Pi Eta*

Laura Anne Denis, BA

John Anthony Derba IV, BA

*Cum Laude*

Nelson Anthony Diaz, BA

Megan Kathryn Dichtl, BA

*Nat Soc Collegiate Scholar*

Alexander John Dickerman, BFA

Stefanie Lucia Diskin, BA

Kateland Elizabeth Dittig, BA

*Magna Cum Laude*

*Lambda Pi Eta*

Mason Charles Dixon, BFA

Lauren Donahue, BA\*

*Nat Soc Collegiate Scholar*

Keith Richard Donovan, BA

Katherine Elizabeth Dowling, BM

Paul Frederick Driscoll, BA

Samantha Rose Dutan, BA

Caitlin Louisa Eddolls, BA\*

Matthew Philip Evans, BA\*

Emma Ann Fairweather, BFA

Emily Elizabeth Fedorko, BA

Alicia T. Ferriaiuolo, BA

Margaret Helen Fitter, BA

*Lambda Pi Eta*

John D. FitzGerald, BA

Kaitlyn Marie Flanagan, BA

*Nat Soc Collegiate Scholar*

Derrick T. Fortin, BA

Brittney L. Fournier, BM

Ariel Esther Frankel, BA

Renee Lise Fredette, BFA

*Summa Cum Laude*

*Nat Soc Collegiate Scholar*

Dylan James Freni, BA

*Nat Soc Collegiate Scholar*

William Brieger Sade Frigon, BA

*Zeta Chi Rho*

Hannah Marie Gagnon, BA

Pamela Rose Galante, BFA

Sandra Jeanette Carrera-Garcia, BA

*Cum Laude*

Malcolm Daley Gent, BA

Summer Elizabeth Gerry, BA

*Upsilon Zeta*

*Nat Soc Collegiate Scholar*

Daniel Arthur Gilbert, BA

Jennifer Eileen Giusto, BFA

*Cum Laude*

*Nat Soc Collegiate Scholar*

Ryan Mark Glavey, BA

*Magna Cum Laude*

Kayla Marie Godin, BA

*Magna Cum Laude*

*Lambda Pi Eta*

Hal David Goldstein, BA

Kellan Patrick Grady, BA

Kristin Marie Greco, BA

Meredith Leigh Green, BA

Tyler Joseph Grillo, BA\*

Cody Thomas Guerrero, BA

Brette Ashley Guilmette, BFA

Erica Crystal Gurley, BA

Victoria Elizabeth Haddad, BA

Emily Anne Halbert, BA

Caroline Elizabeth Hall, BA

Colby M. Hall, BA

Katherine Evelyn Hall, BA\*

Tessa Halsey, BA

Joshua David Hanauer, BA\*\*

Maggie Lamar Hanrahan, BA

Kelsey Houde Hardy, BA, BS

*Summa Cum Laude*

*Nat Soc Collegiate Scholar*

Robin S. Harris, BA, BS\*\*

Parker Bennett Haynes, BA

Melanie Ann Heeren, BA

*Cum Laude*

*Nat Soc Collegiate Scholar*

Lauren Christine Heiser, BA

Samantha Kathleen Hemingway, BA

Peter Anthony Henenberg, BA

Daniel James Hermanowski, BA

Samuel James Hill, BA

Cameron Scott Hodgman, BA

Benjamin Drew Horowitz, BA

*Cum Laude*

Aaron Samuel Howland, BA

Rachel Jordan Hull, BA

Rory Daniel Hurley, BA\*

*Magna Cum Laude*

Amy Beth Hurwitz, BA

*Magna Cum Laude*

*Lambda Pi Eta*

Chelsea Lyn I'Anson, BFA

*Cum Laude*

Danielle Nicole Ireland, BA

*Nat Soc Collegiate Scholar*

Anne Sinclair Johnson, BA

Patrick Michael Johnson, BA

Andrew A. Johnston, BM\*\*

Kimberly Lynn Johnston, BA

Amanda Nicole Jones, BA

*Cum Laude*

Harold Albert Jones, BM

*Cum Laude*

Thomas M. Jorgensen, BA

*Magna Cum Laude*

Rebecca Jean Junnila, BA\*\*

*Magna Cum Laude*

Seth Andrew Kaiser, BFA

Alexander Phillip Kalogeropoulos, BA

*Cum Laude*

*Nat Soc Collegiate Scholar*

Alexander Richard Katz, BFA

Diana Kazan, BA

Molly Jaye Keereweewer, BA

Molly Anne Kelliher, BA

Brendan Thomas Kelly, BA

Andrew Ross Kelsey, BFA

Ann Elizabeth Kelsey, BA

*Nat Soc Collegiate Scholar*

Johnathan Henry Ketelhut, BA

Nicholas David King, BFA

Megan Laura Knowles, BA

*Lambda Pi Eta*

*Nat Soc Collegiate Scholar*

Alexandra Victoria Krauth, BA

*Summa Cum Laude*

Adrienne Marie Krulis, BA

*Pi Delta Phi*

Brooke Ann Lacasse, BA

Alexis Carmella Lamb, BA, AS

Adam P. LaMonica, BA

Cristen Anne Lane, BA

*Cum Laude*

*Lambda Pi Eta*

*Nat Soc Collegiate Scholar*

Barbara Woods Langlais, BA

*Summa Cum Laude*

Joshua David Lapierre, BA

Kyle Allan Larrabee, BA

Kathryn Elizabeth LaVigne, BA

*Magna Cum Laude*

Kyle Mark Leavitt, BA\*

---

COMMENCEMENT 2013

---

Nicole Lacey Lillie, BFA	Leah Adriane Mulroney, BA**	Erica Lynn Ricci, BA
Evan Michael Lospennato, BA	Michael Vincent Murphy, BA	<i>Nat Soc Collegiate Scholar</i>
Joseph Arthur Lotstein, BA	Shannon Marie Murphy, BA	Vanessa Marie Richard, BA
Samuel Gregory Lusted, BA	Chelsea Christine Nickerson, BFA	Colin L. Riddle, BA
<i>Magna Cum Laude</i>	Megan Faith Nickerson, BA*	Scott Michael Riess, BA
Kelsey Elizabeth Lynch, BA	Jordan Lynn Noeding, BFA	<i>Cum Laude</i>
Ignazio Enzo Macaluso, BFA	<i>Nat Soc Collegiate Scholar</i>	<i>Nat Soc Collegiate Scholar</i>
<i>Cum Laude</i>	Samantha Elizabeth Norton, BA	Shaylyn Paige Riley, BFA
Joseph Richard MacDonald, BFA	<i>Cum Laude</i>	Alex Michael Rinaldi, BA
Sarah Aurelia MacDonald, BA*	Mary Grace Novotny, BA	<i>Cum Laude</i>
<i>Nat Soc Collegiate Scholar</i>	Blake Andrew Nyman, BA**	<i>Nat Soc Collegiate Scholar</i>
Emily Jane MacKenzie, BA	Hillary Ann O'Brien, BA	Deirdre Ann Rinaldi, BA
Andrea Marie Macri, BFA	<i>Magna Cum Laude</i>	Chelsea Paige Rind, BFA
Sean Michael Mahoney, BFA	Kristine Carlsson O'Brien, BA	Benjamin Cutler Rines, BA
Kelly Kathleen Maloney, BA	Andrew Foster Ogden, BA	<i>Pi Delta Phi</i>
Michael Travis Manfred, BFA	Samuel John Pacheco, BA	<i>Nat Soc Collegiate Scholar</i>
<i>Nat Soc Collegiate Scholar</i>	Christopher John Palermo, BA	Matthew O. Rogers, BA
Christopher Alan Marion, BA*	Andrea Nicole Palmentiero, BA	Alison Anne Rollins, BA
Megan Catherine Markus, BA	David Jeremy Parker, BM	<i>Lambda Pi Eta</i>
Carley S. Marston, BA	David William Pastore, BA	Victoria Maria Ronan, BA
Steven Anthony Martins, BA	Marie Lynn Paternoster, BA	<i>Lambda Pi Eta</i>
Caterina Faythe Masia, BA	Tyler John Patria, BA	Christopher William Ruble, BA
<i>Cum Laude</i>	Clinton William Paulenka, BA	Rebecca Michelle Russell, BFA
<i>Nat Soc Collegiate Scholar</i>	Kyle E. Pember, BA	<i>Cum Laude</i>
Sierra Channing Mayberry, BA	Sarah Noelle Perrotti, BA	Laura Elizabeth Ruttle, BA
Caleb Michael McCandless, BA	Nicole Jessica Perry, BFA	<i>Magna Cum Laude</i>
<i>Cum Laude</i>	Robert Foster Pettit, BA	<i>Phi Alpha Theta</i>
Jackson Maille McClure, BA	Michelle Marie Picard, BA	<i>Nat Soc Collegiate Scholar</i>
Kerri A. McCormack, BM**	<i>Lambda Pi Eta</i>	Matthew Lee Rynkowski, BA
Matthew Joseph McCue, BM	Rebecca Sheffield Pine, BA	Anna Kathryn Schelble, BA
Bryan Peter McFadden, BA	William James Piro Jr., BA	<i>Zeta Chi Rho</i>
Katherine Joan McGarity, BA	Christopher Paul Plankey, BA	Brian L. Schnee, BA
Cameron Pierce McMaster, BA	Rachelle Elise Poirier, BA	<i>Nat Soc Collegiate Scholar</i>
Jamie Joseph Messina, BA	<i>Kappa Delta Pi</i>	Christine Victoria Scobi, BA
Joseph Michael Meuse, BA	Brittany Elizabeth Porter, BA	Megan Lyn Scott, BA
<i>Summa Cum Laude</i>	<i>Cum Laude</i>	Daniel Allen Selleck, BA
<i>Lambda Pi Eta</i>	Joshua Joseph Porter, BA	Wesley Charles Serafine, BA
<i>Nat Soc Collegiate Scholar</i>	Samantha Lynn Possemato, BA	Dillon Eaton Simpson, BA
Alyssa A. Meyer, BA	<i>Kappa Delta Pi</i>	Taylor James Edward Simpson, BA
Kyle David Michaud, BA	Jennifer Suzanne Prunier, BA	Eliza Norton Smiley, BA**
<i>Cum Laude</i>	Chelsey Trisha Puza, BA	<i>Magna Cum Laude</i>
<i>Nat Soc Collegiate Scholar</i>	<i>Lambda Pi Eta</i>	<i>Keene State Honors Program</i>
Joseph Charles Mintel, BM	Brian Joseph Rabadeau, BA	Katlyn Rose Smirkowski, BA
Jessica Noel Monteneri, BA*	Susanna Virginia Rainey, BA	<i>Nat Soc Collegiate Scholar</i>
<i>Cum Laude</i>	<i>Magna Cum Laude</i>	Teagan Noelle Soucy, BA**
Benjamin David Montmagny, BA	<i>Lambda Pi Eta</i>	Colette Renee St Amour, BA
<i>Alpha Psi Omega</i>	Joseph Robert Raposa, BA	Sean Timothy St Germain, BA, BS
Kyle Andrew Moors, BFA	Hannah Stasia Rascoe, BA	Jodie Rae St Onge, BFA
Neil Ryan Morneau, BA	Amanda Elizabeth Razzaboni, BA**	<i>Magna Cum Laude</i>
Leia Elizabeth Morris, BA	Mariah Louise Reed, BA	<i>Nat Soc Collegiate Scholar</i>
<i>Lambda Pi Eta</i>	Collette Marie Reynolds, BA	Caitlin Anna Stearns, BFA

Kimberly Erin Stickler, BFA, BA  
 Abigail Elizabeth Stuart, BA\*\*  
 Kristine Brooke Sullivan, BM  
 Jeffrey D. Sumner, BA  
 Michael Evan Superneau, BA  
 Charlotte A. Sweet, BA  
 Amanda Lauren Swift, BA  
 Adam Michael Teich, BA  
 Samantha Hope Therieau, BA, BS  
 Natalie Ann Thomson, BA  
*Magna Cum Laude*  
*Zeta Chi Rho*  
 Courtney Elizabeth Thorpe, BA  
 Samantha Jill Toomey, BA  
 James Andrew Trask, BA  
 Stephen J. Trinkwald, BA  
 Monique Elizabeth Troiano, BA  
*Cum Laude*  
*Lambda Pi Eta*  
*Nat Soc Collegiate Scholar*

Richard Oscar Tucker, BA\*\*  
 Samantha Jean Turcotte, BA  
 Brooke Lindsey Tuttle, BA\*\*  
 Sean Alfred Ulversoy, BA  
 Kyle Richard Underwood, BA  
*Nat Soc Collegiate Scholar*  
 Mary Paige Vogt, BA  
 Dana Ryan Ward, BFA\*\*  
 Marcy Jean Webster, BA  
*Magna Cum Laude*  
*Nat Soc Collegiate Scholar*  
 Kevin Michael Weed, BA  
 Alexandra S. Wessel, BA\*\*  
 Clayton David Whalen, BA\*  
 Sarah Elizabeth Wharton, BA  
*Lambda Pi Eta*  
*Nat Soc Collegiate Scholar*  
 Victoria Rose White, BFA  
*Summa Cum Laude*  
*Nat Soc Collegiate Scholar*

Marie Katherine Whitney, BA  
*Summa Cum Laude*  
 Bridgette Marie Wiesenauer, BFA  
*Cum Laude*  
 Kayla Marie Wilbur, BA  
 Jake Anthony Williams, BA  
 Kelli Ann Wilson, BA  
*Phi Alpha Theta*  
*Nat Soc Collegiate Scholar*  
 Kyle Basil Winston, BA\*  
 Robert Lewis Winthrop, BA  
 Sarah J. Wolff, BA\*  
*Kappa Delta Pi*  
*Nat Soc Collegiate Scholar*

## Sciences and Social Sciences

---

Frank William Abbate, BS, BA\*\*  
 Michael Patrick Abbott, BS  
 Matthew John Adams, BA  
*Kappa Mu Epsilon*  
 Vanessa Lynn Ainsworth, BA  
 Alyssa Elizabeth Allen, BA  
*Nat Soc Collegiate Scholar*  
 Jennifer Ashley Allen, BA  
*Summa Cum Laude*  
*Nat Soc Collegiate Scholar*  
 Keera Lee Allen, BA  
*Cum Laude*  
*Alpha Kappa Delta*  
*Nat Soc Collegiate Scholar*  
 Joseph Kevin Almeida, BS  
 Lior Alon, BA, AS  
*Magna Cum Laude*  
*Psi Chi*  
 Christina Marie Alvarez, BS  
*Nat Soc Collegiate Scholar*  
 Elizabeth Marie Amaral, BA  
*Magna Cum Laude*  
 Jessica Lynne Ames, BA\*\*  
 Jason Bruce Anderson, BS  
*Magna Cum Laude*  
*Upsilon Pi Epsilon*

Sarah MacDonald Anderson, BS  
*Cum Laude*  
*Beta Beta Beta*  
 Christopher Thomas Andrews, BA\*\*  
 Amelia Michele Armstrong, BA  
*Cum Laude*  
*Gamma Theta Upsilon*  
 Cole M. Armstrong, BA  
 Michael Joseph Ausiello, BA  
 Corey Paul Austin, BS  
*Cum Laude*  
*Upsilon Pi Epsilon*  
*Nat Soc Collegiate Scholar*  
 Chelsea Marie Bachand, BA  
 Shallyne Yudelca Baez, BA\*  
 Daniel Patrick Bailey, BA  
 Sean P. Bailey, BA  
 David Paul Balboni, BS  
 Abigail Katherine Ball, BA  
*Kappa Mu Epsilon*  
 Brianna Nicole Ball, BA\*  
 Elizabeth Andrea Baptie, BA  
 Ariana Barone, BS  
 Gregory J. Bates, BA  
 Katrina Elise Baumgartner, BA  
*Magna Cum Laude*  
*Nat Soc Collegiate Scholar*

Bethany R. Beaudet, BA  
 Christopher John Beland, BS  
*Cum Laude*  
*Nat Soc Collegiate Scholar*  
 Brooke Kathleen Bergeron, BA  
 Dominic Kenneth Bianchi, BA  
 Joshua Aaron Binder-Brantley, BA  
*Cum Laude*  
 Phylicia Leona Ann Bischof, BA  
*Upsilon Zeta*  
 Adam Kaleb Black, BS  
 Daniel James Blomerth, BS\*\*  
 Jessica Lynn Boland, BA  
*Magna Cum Laude*  
*Kappa Delta Pi*  
*Kappa Mu Epsilon*  
 Christopher M. Bolsch, BS  
 Rebecca Ashley Bolton, BA  
 Jaclyn Marie Borrelli, BA, BS\*\*  
 Michael Joseph Borruso, BS\*\*  
 Caitlin Elizabeth Bowen, BA  
*Kappa Delta Pi*  
*Kappa Mu Epsilon*  
*Nat Soc Collegiate Scholar*  
 Adam N. Braley, BS  
*Nat Soc Collegiate Scholar*  
 Michael William Broder, BA

---

COMMENCEMENT 2013

---

Maureen Elizabeth Brooks, BA  
 Patrick Durham Brough, BA  
*Gamma Theta Upsilon*  
 Samuel Nelson Brown, BA, BS  
 Kristopher John Bucyk, BA  
*Cum Laude*  
*Kappa Mu Epsilon*  
 Meghan Elizabeth Butcher, BA  
*Magna Cum Laude*  
 Tristan Norman Penberthy Butler, BS  
 Michiel Robert Byington, BS  
*Summa Cum Laude*  
 Nichole Jordan Cabaleiro, BS  
*Nat Soc Collegiate Scholar*  
 Brooke A. Callaway, BS\*\*  
 Kristina Elizabeth Cannon, BS  
*Cum Laude*  
*Nat Soc Collegiate Scholar*  
 Cristina Elizabeth Cappucci, BA  
 Matthew Richard Caputo, BA  
*Magna Cum Laude*  
*Kappa Mu Epsilon*  
 Stephanie Elizabeth Caravedo, BS  
 Adrianna Marie Cardinal, BA  
 Colleen Elizabeth Carey, BS  
 James William Carmichael, BA  
 Adam Ryan Carr, BS  
*Magna Cum Laude*  
 George Christopher Carter, BA  
 Brian William Casey, BS  
 Ian Patrick Raymond Casey, BS, BA\*\*  
*Cum Laude*  
*Pi Delta Phi*  
 Matthew A. Casey, BA  
 Matthew Arthur Casey, BS  
 Brett Robert Casna, BS  
*Beta Beta Beta*  
 Sarah Ann Chabot, BA  
 Stacey Lee Chalupka, BS  
 Sarah Elizabeth Chase, BA  
*Cum Laude*  
*Alpha Kappa Delta*  
 Meghan Sarah Chiasson, BS  
*Magna Cum Laude*  
 Alex Paul Chrusciel, BA  
 Nicole Lisa Cianciulli, BA  
 Audrey Elizabeth Clairmont, BA, AS  
*Cum Laude*  
*Nat Soc Collegiate Scholar*  
 Brendan Evan Clement, BS

Chelsea Morrison Clouse, BS  
*Magna Cum Laude*  
*Nat Soc Collegiate Scholar*  
 Jenna Lynn Cobb, BA  
*Psi Chi*  
 Kevin R. Coles, BA\*  
 Alexas Parkinson Connell, BA  
 Brennan Alice Connors, BA  
 Alyse Joy Coogan, BA  
*Psi Chi*  
 Amy Elisabeth Cooper, BA  
*Magna Cum Laude*  
 Abigail Elizabeth Copp, BA  
 Kate Lee Cordner, BA  
 Caitlin Elizabeth Cotter, BS  
 Alexandra Beth Couch, BS  
 John Francis Coughlin, BS\*  
 Derek Alan Cowan, BS  
 Charlene Gail Crefeld, BA, AS  
 Caitlyn Marie Croasdale, BS  
 Baileigh F. Crooker, BA  
 Raquel Christine Crumley, BA\*\*  
 Meaghan Aileen Cunningham, BA  
 Alexander Paul Cuomo, BA  
 Lorne Bradbury Currier, BS  
 Natalie Anderson Dayton, BS  
 Ariel Katherine DeLaura, BA\*  
 Jacqueline Jana DeMaio, BA\*\*  
 Joseph Allen Demers, BA  
 Ethan Mark DePuy, BA\*\*  
 Jessica Lynn Desclos, BS  
 Gregory Michael Devaux, BA  
 Benjamin Matthew Deyo, BS  
 Annie Elizabeth Dintino, BA  
*Cum Laude*  
*Nat Soc Collegiate Scholar*  
 Benjamin Dovidio, BS\*\*  
 Brendan Michael-Wesley Doyle, BA  
 Brooks Michael Dubois, BS  
 Katherine Grace Dudak, BS  
 James Kent Dunlap, BS  
 Christopher Michael Dunn, BA  
*Gamma Theta Upsilon*  
 Lorin Nicole Dupuis, BS  
 Nicole Cathleen Dupuis, BS  
 Alexander Ryan Dutton, BA  
*Cum Laude*  
*Nat Soc Collegiate Scholar*  
 Tierney Ann Dwyer, BA  
 Rebecca Beth Eisenberg, BA  
 Brian Seneca Eldredge, BA  
 Taryn Anne Erb, BS

Kaitlin Elizabeth Erunski, AS\*  
 Miranda Amy Ervin, BA  
 Colin Quinn Farley, BS  
 Seth Miguel Farmer, BA  
*Magna Cum Laude*  
 Drew Christopher Farrar, BS\*  
 Leah Katherine Femia, BA  
 Emily Elizabeth Ferlo, BA  
*Magna Cum Laude*  
*Eta Sigma Gamma*  
*Nat Soc Collegiate Scholar*  
 Bryan Michael Finocchiaro, BA  
*Gamma Theta Upsilon*  
 Davis Glenn Fitch, BA  
 Scott Stevens Folsom, BA\*\*  
*Magna Cum Laude*  
*Psi Chi*  
*Nat Soc Collegiate Scholar*  
 Amy Elizabeth Ford, BS\*\*  
 Peter Malcolm Fraser, BS  
 Michael F. Frate, BS\*  
 Joseph D. Frigo, BS  
 Ethan Patrick Gage, BS  
 Desiree C. Gagne, BA  
*Nat Soc Collegiate Scholar*  
 Krystal Lee Gagnon, BA  
 Melanie Marie Gagnon, BA\*\*  
 Adam Norbert Gallant, BS\*  
 Daniel Denis Garant, BS, BA  
*Summa Cum Laude*  
*Upsilon Pi Epsilon*  
 Kristen Theresa Gedenberg, BS  
*Cum Laude*  
 Phillip Stewart Geer, BS\*  
 Allison Taylor Ghirardi, BA, BS\*\*  
 Renee M. Giles, BA  
 Emily Esta Gingrich, BA  
 Brendan Matsen Girouard, BS\*  
 Kristopher William Glimenakis, BS\*\*  
 Casey Wendy Glynn, BA  
 Illyana Elizabeth Golden, BA\*  
*Cum Laude*  
 Cameron Brian Gould, BA\*\*  
 Ryan Stephen Gould, BA  
*Gamma Theta Upsilon*  
 Janell Ashley Smith Grassman, BA, BS\*\*  
 Michael James Grazewski, BA  
*Omicron Delta Epsilon*  
 Nicholas C. Greenwood, BA  
 Jennifer Elizabeth Grivers, BA  
*Kappa Delta Pi*

---

COMMENCEMENT 2013

---

Mason Everett Grugnale, BA <i>Cum Laude</i> <i>Nat Soc Collegiate Scholar</i>	Matthew Ryan Kelly, BS* Christopher Joseph Kennedy, BS <i>Summa Cum Laude</i>	Seth Michael MacLean, BA <i>Cum Laude</i>
Christopher August Gruner, BS	Wade Austin Kornreich, BA	William David MacPherson, BS
Glenn Alan Guilmette, BS	Joseph Francis Kowalski IV, BS	Sarah Beth Maichel, BS** <i>Cum Laude</i>
Janel Evelyn Haggerty, BA	Shaun Kozlowski, BA	Sylvana Lisa Maione, BS** <i>Summa Cum Laude</i>
Stephanie Marie Hamel, BA <i>Cum Laude</i>	Shannon Theresa Krauss, BS <i>Cum Laude</i>	<i>Nat Soc Collegiate Scholar</i>
Cody Nathaniel Leon Harriman, BA <i>Cum Laude</i>	Lyndsay Taylor Krisel, BA	Max William Marek, BA <i>Cum Laude</i>
Daniel James Haslam, BS	Brittany Karin Kunkel, BA <i>Psi Chi</i>	Emily Rose Marhan, BA <i>Cum Laude</i>
Timothy Isham Hastings, BS <i>Magna Cum Laude</i>	Christopher James Labrie, BA <i>Cum Laude</i>	<i>Alpha Kappa Delta</i>
Ethan Matthew Hawkins, BA <i>Summa Cum Laude</i> <i>Psi Chi</i>	Nicole Kristie Lackie, BA	Rachel Naomi Markman, BA
Luke Philip Hebert, BA	Andrew Philip Lampron, BS <i>Cum Laude</i> <i>Gamma Theta Upsilon</i>	Marc Claud Marois, BS* Julianna Emily Marone, BA <i>Cum Laude</i> <i>Psi Chi</i>
Jennifer Christian Hicks, BA** <i>Psi Chi</i>	Jason Corey Lapinsky, BA*	Rachel Christine Marra, BS
Jordan Steele Hicks, BA <i>Nat Soc Collegiate Scholar</i>	Emma Adams Laramie, BA	Kaitlin Amber Marsh, BA
Christopher Matthew Hill, BS	Danielle Nicole LaRock, BA	Kaleigh Marie Marston, BA
Christopher Dickinson Hinchey, BA	Georgi Anne Latosh, BS <i>Summa Cum Laude</i>	Joseph Patrick Martin, BA
Kerri M. Hinkle, BS**	James Donald Lavimoniere, BA	Lisa Marie Martin, AS
Emma Katherine Hockmuth, BA	Jeramey Arthur Lawler, BS	Camille Marie Martineau, BA <i>Kappa Delta Pi</i>
Lauren Nicole Holden, BA	Jillian Noel Leclaire, BA <i>Nat Soc Collegiate Scholar</i>	Olivia Ann Martinotti, BA
Cody Patrick Holliday, BS	Rebecca Suzanne Leclerc, BA <i>Magna Cum Laude</i> <i>Upsilon Zeta</i> <i>Alpha Kappa Delta</i>	Nicholas Christopher Marx, BA
Philip Alan Horn, BS*	Marisa Erin Lefebvre, BA	Isabella Ann Matos, BA
Rikki Marie Hornfeldt, BA	Courtney Lee Leggett, BS <i>Magna Cum Laude</i>	Allison Ruthann May, BA*
Bridget Quinn Houlihan, BA	Kevin John LeSage, BA**	Tyler Richard McAlevy, BA
Erin Heath Humphrey, BA	Kelley Levine, BA <i>Summa Cum Laude</i> <i>Gamma Theta Upsilon</i>	Gregory Richard McCormick, BA <i>Cum Laude</i> <i>Keene State Honors Program</i> <i>Gamma Theta Upsilon</i>
Michael Christopher Jacome, BA	Heather M. Lewis, BS**	Christa Claire McGaha, BA
J Michael Jarvela, BS	Melissa Iris Lipkind, BA	Emma Canavan McHugh, BS
Kimberly Anne Johnson, BA	David Bernard Lisle, BS	Jonathan William McInerney, BS
Sinea Mary Johnson, BA	Melanie Jean Lizotte, BA <i>Cum Laude</i>	Crystal Marie McKenzie, BS
Daniel Raymond Jones, BS <i>Cum Laude</i>	Holly Kathleen Lootz, BA <i>Psi Chi</i>	Tyler James McWhirk, BS
Aimee Marie Joyce, BS	Bridget Elizabeth Love, BA <i>Zeta Chi Rho</i> <i>Alpha Kappa Delta</i>	Jocelyn Elizabeth Meade, BA
Katelyn Ashley Joyce, BA <i>Magna Cum Laude</i> <i>Psi Chi</i>	Alexi Taylor Lovechio, BS	David Maxwell Mendelsohn, BA
Kayla Mary Joyce, BA, AS**	Mathew Christian Lugo, BA	Raymond Henry Menier, BA
Nicole Elizabeth Judge, BA**	Graham Michael Lynch, BA <i>Summa Cum Laude</i>	Justine Nicole Miano, BA
Mary Katherine Junget, BS**		Courtney Leigh Miller, BA <i>Cum Laude</i> <i>Nat Soc Collegiate Scholar</i>
Melissa Jo Kaplan, BA		Amanda Corona Mills, BS <i>Nat Soc Collegiate Scholar</i>
Kimberly Kasprak, BS		Melissa Mills, BA
Joseph David Katin, BA		Ronald Scott Miner, BS
Jaycelyn Ann Kay-Pfenning, BS <i>Upsilon Zeta</i> <i>Nat Soc Collegiate Scholar</i>		Quinn Nugent Molloy, BA <i>Magna Cum Laude</i>
Jacquelyn Carolyn Kearney, BA <i>Nat Soc Collegiate Scholar</i>		

---

COMMENCEMENT 2013

---

Eric Michael Moran, BA  
 Christopher William Morin, BS, BA  
 Kerry Virginia Morlock, BS  
 Andrew James Morris, BA  
 Julie Ann Moses, BA  
 Tyler R. Munson, BS  
 Alexandria Elizabeth Murby, BA  
*Kappa Mu Epsilon*  
 Samantha Elizabeth Murphy, BA  
 Matthew Connors Murray, BS  
 Alyx Marisa Nardini, BA  
 Meredith K. Nash, BA\*\*  
 Ryan Rockwell Nay, BS\*  
 Natalie Alise Neilson, BA  
*Summa Cum Laude*  
*Psi Chi*  
 Stephen T. Nelson, BS\*\*  
 Andrea Lynn Neri, BA  
*Cum Laude*  
 Christy Lee Nguyen, BA  
 Shane Michael Norris, BS  
 Katharine D. Nunes, BA  
*Magna Cum Laude*  
*Kappa Mu Epsilon*  
 Ryan Thomas O'Connor, BS  
 Alexander Daniel Odell, BS  
 Robert Emmett O'Neill, BS  
 Cassandra Ann Orr, BA  
*Zeta Chi Rho*  
 Kayla M. Papalian, BA  
*Beta Beta Beta*  
*Nat Soc Collegiate Scholar*  
 Jesse Paul Park, BA  
 Matthew Steven Parkes, BA  
*Magna Cum Laude*  
*Zeta Chi Rho*  
 Nicholas James Pasquale, BA  
*Cum Laude*  
 Julia Suzanne Pauciello, BA  
*Psi Chi*  
 Sarah Anne Pearson, BA  
 Sierra Naomi Pearson, BA  
 Denise Brenda Perna, BA  
 Eric Wright Perrault, BS\*\*  
 Christine Val Chisholm Perry, BS  
*Magna Cum Laude*  
 Alexa Michelle Pfeffer, BS\*  
 Amanda Lynn Phillips, BA  
 Michaela Marie Picco, BA  
 Seth William Pierce, BS  
 Jaclyn Marie Pileeki, BS

Jennifer Pires, BA  
*Psi Chi*  
 Ryan Michael Pothier, BS  
 Christopher Munn Prince, BA\*\*  
 Amy Lois Proctor, BA  
 Kelsi Lee Pronovost, BA  
 Meryl Ann Ragaini, BA\*\*  
 Samuel Graham Rand, BA\*  
*Gamma Theta Upsilon*  
 Brytani Elise Randlett, BA  
 Kristen Ann Rankin, BA  
 Zanub S. Raza, BS  
 Emily Agnes Ricardi, BS\*  
*Rho Sigma Kappa*  
 Adam James Riffle, BA  
 Jeremy M. Robbins, BS\*  
*Nat Soc Collegiate Scholar*  
 Ashley Nicole Roberts, BA  
*Summa Cum Laude*  
 Kelsey Lynn Roberts-Donahue, BA  
 Kristin Ellen Robidoux, BA  
 Emily Marie Robinson, BA\*\*  
 Hailey Nicole Rogozinski, BS  
 Kaitlyn Elizabeth Rosato, BS  
*Beta Beta Beta*  
 Chelsea Jean Rouff, BA  
*Cum Laude*  
*Psi Chi*  
*Nat Soc Collegiate Scholar*  
 Spenser James Roy, BA\*  
 Daniel W. Russell, BS  
 Rachel Ann Ryan, BA  
 Melanie B. Sachs, BA  
*Alpha Kappa Delta*  
 Alisa Mary Santangelo, BA  
 Kristina Nancy Sargent, BA  
 Elena Savidis, BA  
 Derek R. Scadova, BS\*\*  
 Richard Scappaticci Jr., BS  
*Cum Laude*  
*Delta Mu Delta*  
 Monica Lynn Schauss, BA  
*Beta Beta Beta*  
 Kristen Carty Schmidt, BS\*\*  
 Zachary Reagan Schneider, BS  
 David Benjamin Schuster, BA  
 Emma Faye Schwartz, BA  
 Mikaela Dane Scozzafava, BA  
 Andrew David Sears, BA  
 Felix Victor Seidel, BA  
*Summa Cum Laude*

David Lowell Sell, BS  
*Magna Cum Laude*  
*Upsilon Pi Epsilon*  
 Kyle Alexander Sexton, BS\*\*  
 Kristen Nicole Shannon, BA  
 Karli Ann Shepherd, BA  
 Glenn Manuel Silva, BS  
 Michael Joseph Silva, BA  
*Nat Soc Collegiate Scholar*  
 Jason C. Skibek, BS  
 Chelsea Krystin Slogic, BS  
*Cum Laude*  
*Nat Soc Collegiate Scholar*  
 Cory Allen Smith, BS  
 Kaitlin Leigh Smith, BS\*  
 Kathryn Elizabeth Smith, BA  
 Deena Bess Snoke, BS  
*Cum Laude*  
*Beta Beta Beta*  
*Nat Soc Collegiate Scholar*  
 Kimberly Suzanne Sollows, BA  
*Summa Cum Laude*  
*Psi Chi*  
 Nicole Elizabeth Souza, BA  
 Samantha Erin Souza, BA  
*Alpha Kappa Delta*  
 Rebecca Elizabeth Spidaliere, BS  
*Cum Laude*  
*Delta Mu Delta*  
 Amanda Joyce Stalbird, BA  
*Psi Chi*  
 Adam James Stanclift, BA\*\*  
 Sean R. Steele, BA\*  
 Kyle Joseph Sterl, BS\*  
 Ashley E. Stewart, BA  
 Jennifer Irene Stickle, BA, AS\*  
 Andrew Jeffrey Stowell, BS\*\*  
*Cum Laude*  
 Danielle Sarah Strauss, BA, AS  
 Andrew Fitzgerald Sullivan, BS  
 Christine Laura Sullivan, BS  
*Lambda Pi Eta*  
 Lauren Keyes Sutherland, BA  
 Andrew Joseph Sutton, BS\*  
*Magna Cum Laude*  
 Elizabeth Fay Suzio, BA  
*Alpha Kappa Delta*  
 Keith Richard Sykes, BA  
*Magna Cum Laude*  
*Nat Soc Collegiate Scholar*  
 Ronald Oliver Szarkowski, BA

Meghan Elizabeth Szymt, BA <i>Beta Beta Beta</i>	Zachary Nicholas Vouros, BA Hannah Elisabeth Walker, BA <i>Summa Cum Laude</i> <i>Keene State Honors Program</i>	Ashley Catherine White, BS* Autumn Marie White, AS Elise Marie White, BS Taylor William Wicke, BA** Amanda Clare Wiley, BA** Ciara Cailin Wiley, BA <i>Magna Cum Laude</i>
Craig Matthew Tack, BS John Wayne Tetlow, BA Michael Rutherford Thompson, BS <i>Nat Soc Collegiate Scholar</i>	Kristin J. Walsh, BS <i>Nat Soc Collegiate Scholar</i>	Chance Raymond Wilk, BS Katelyn Clarice Williams, BA Molly Canham Williams, BA Brittany M. Wilson, BA Devan Nicole Witzenbocker, BA Chertina Nicole Woodard, BA Ellen Rose Woodward, BA, AS
Matthew Giles Topper, BA James Justin Towne, BS** Alyssa Erin Tremblay, BA* Alexander Tress, BA <i>Nat Soc Collegiate Scholar</i>	Avery Christian Walter, BA Sarah Elizabeth Wampler, BA <i>Cum Laude</i> Ashlee Marie Wansick, BA Hunter Evan Ward, BS* Britni Marie Watkinson, BS <i>Beta Beta Beta</i>	Hannah Fey Yensan, BA Heather Lynn Young, BA <i>Magna Cum Laude</i> <i>Omicron Delta Epsilon</i>
Jenna Elizabeth Turner, BA** Kerry Turner, BA** Chelsea Elise Tyler, BA Olivia Berni Vagnoni, BA <i>Cum Laude</i>	Chelsey Victoria Watson, BA Jennifer Clare Watson, BA David Justin Webb, BS <i>Cum Laude</i> <i>Gamma Theta Upsilon</i>	Ryan Stephen Young, BA Elin Suzanne Zoellick, BA
Matthew Thomas Vest, BS* Thomas Martin Vestal, BA Stephen Joseph Vitko, BS <i>Gamma Theta Upsilon</i>	Tyler J. Webster, BS Kristen Elizabeth Weidmann, BA Collin Jamison Whalen, BA	
Sara Holmes Voorhis, BS**		

## Professional Studies

---

Kimberly Anne Aalberg, BS, BA <i>Magna Cum Laude</i> <i>Kappa Delta Pi</i>	Taylor Lee Azarian, BS <i>Magna Cum Laude</i> <i>Nat Soc Collegiate Scholar</i>	Evan Charles Bennett, BS Kyle G. Bennett, BS Devlyn Helen Marie Bent, BS <i>Pi Delta Phi</i>
Kara Nicole Abbott, BS JASON Nathanael Abram, BS <i>Magna Cum Laude</i> <i>Nat Soc Collegiate Scholar</i>	Richard Seth Babel, BS Avrianna Celeste Bacchiocchi, BS Sarah Anna Baker, BS* <i>Cum Laude</i> <i>Nat Soc Collegiate Scholar</i>	Melanie Ela Berry, BS Spencer Louis Bertram, BS Emily H. Bickford, BS Alexandra Leigh Billert, BS <i>Magna Cum Laude</i> <i>Eta Sigma Gamma</i>
Kyle Edward Adams, BS <i>Cum Laude</i> <i>Eta Sigma Gamma</i> <i>Nat Soc Collegiate Scholar</i>	Jesse James Bardis, BS <i>Summa Cum Laude</i> <i>Phi Epsilon Kappa</i>	Brittany Marie Bineau, BS Christina Claire Binns, BS Jacob Wayne Blake, BS <i>Magna Cum Laude</i> <i>Nat Soc Collegiate Scholar</i>
Emily Virginia Albin, BS Shammara Akia Al-Darraj, BS <i>Phi Epsilon Kappa</i>	Nazmine Bazizane, BS <i>Cum Laude</i>	Kate Emily Boardman, BS Elise Marie Bolster, BS Robert Joseph Bouchey, BS Heather Lynn Boutin, BS*
Charles Borton Allen Jr., BS Kyle Philip Almeida, BS Danielle Elizabeth Almon, BS, BA <i>Kappa Delta Pi</i>	Nathan William Bearse, BS** Kaitlin Marie Beaulieu, BS DeeAnn Marie Behnke, BS <i>Cum Laude</i>	Joseph Robert Breckell, BS <i>Cum Laude</i> <i>Rho Sigma Kappa</i>
Sapna Arun Kumar Amin, BS <i>Magna Cum Laude</i>	Elizabeth Ann Behr, BS <i>Magna Cum Laude</i> <i>Kappa Delta Pi</i>	Julia Anne Brenker, BS <i>Rho Sigma Kappa</i> <i>Nat Soc Collegiate Scholar</i>
Jake Turner Atherton, BS <i>Rho Sigma Kappa</i>	Kelly A. Beliveau, BS** <i>Kappa Delta Pi</i>	
Tabitha Jean Aubee, BS* Brieana Mae Aumand, BS** <i>Cum Laude</i> <i>Upsilon Zeta</i>	Chelsea A. Bell, BS** Edward Lloyd Meyer Bell, BS	

---

\* Expected to meet graduation requirements in September 2013

---

COMMENCEMENT 2013

---

Megan Michelle Briggs, BS <i>Cum Laude</i> <i>Kappa Delta Pi</i>	Haley Kathleen Chandler, BS, BA <i>Magna Cum Laude</i>	Kathrine Rose D'Albis, BS <i>Nat Soc Collegiate Scholar</i>
Taylor Kennedy Briggs, BS* <i>Rho Sigma Kappa</i>	Marissa Lynn Chase, BS	Kimberly Claire Dashefsky, BS
Lucas Moses Broadley, BS	Max M. Chase, BS <i>Cum Laude</i>	Eric Brow Dasho, BS <i>Rho Sigma Kappa</i>
Arthur James Brockelman, BS	Kate Lynn Chimienti, BS <i>Phi Epsilon Kappa</i>	Sarah Davidson, BS*
Gabriela Noel Brodeur, BS** <i>Cum Laude</i> <i>Lambda Pi Eta</i>	Victoria Anne Chloros, BS <i>Cum Laude</i> <i>Eta Sigma Gamma</i> <i>Nat Soc Collegiate Scholar</i>	Rebecca Kay Davis, BS
Lauren Denise Brown, BS	Sandra R. Chow, BS*	Dustin Louis DeBernardi, BS
Megan Pater Brown, BS, BA** <i>Cum Laude</i>	Ryan Matthew Christopher, BS	Lauren Marie DeGennaro, BS
Stephanie Elizabeth Brown, BS	Stephen Anthony Cipriani, BS	Allison Hanson Delyani, BS, BA** Joseph Niccolo DeMasco, BS <i>Rho Sigma Kappa</i>
Amanda Joan Buckley, BS <i>Eta Sigma Gamma</i>	Ashley Elizabeth Clarke, BS	Samantha Lynn Desmarais, BS
Hannah Bujewicz, BS <i>Cum Laude</i> <i>Eta Sigma Gamma</i>	Alexandra Ann Claus, BS <i>Magna Cum Laude</i> <i>Keene State Honors Program</i> <i>Nat Soc Collegiate Scholar</i>	Gatluk Gatluak Diew, BS <i>Rho Sigma Kappa</i>
Joshua Van Burba, BS*	Brianna Paris Clayton, BS	Sara Rea Dilling, BS
Dakota Robert Burbank, BS	Erin Elizabeth Cogan, BS, BA <i>Cum Laude</i> <i>Kappa Delta Pi</i> <i>Nat Soc Collegiate Scholar</i>	Kristijan Djulabic, BS <i>Nat Soc Collegiate Scholar</i>
Ashley Virginia Burk, BS, BA <i>Kappa Delta Pi</i>	Riley Thomas Cohen, BS <i>Magna Cum Laude</i> <i>Phi Epsilon Kappa</i>	William Harry Dodge, BS
Chelsea Jean Burke, BS* <i>Nat Soc Collegiate Scholar</i>	Christopher Charles Colbert, BS	Christopher George Dosch, BS**
Sean Michael Burkhart, BS	Christine Evelyn Collins, BS** <i>Kappa Delta Pi</i>	Amanda J. Doten, BS**
Kevin Guy Byrne, BS**	Kelsey Dodd Connolly, BS	Cody Charles Doyle, BS
James Bennett Cahan, BS, BA <i>Cum Laude</i> <i>Pi Delta Phi</i>	Andrew Tyler Conrad, BS	Amy Lauren Duffy, BS <i>Cum Laude</i> <i>Eta Sigma Gamma</i>
Tiffany Flik Calcutt, BS <i>Magna Cum Laude</i> <i>Eta Sigma Gamma</i>	Laurie Elizabeth Costa, BS	Sarah Lynn Dupuis, BS <i>Cum Laude</i>
Brittany N. Cammisia, BS <i>Cum Laude</i> <i>Eta Sigma Gamma</i>	Beth Marie Cote, BS	Hunter Samuel Durfee, BS <i>Magna Cum Laude</i> <i>Kappa Delta Pi</i>
Siobhan Paula Carnell, BS	Nicole Jeannine Cote, BS	Katarzyna Anna Duz, BS**
Colleen Marie Carroll, BS, BA**	Joseph Emilio Covino, BS	Holly Anne Elliott, BS <i>Cum Laude</i>
James Carroll, BS	Brendan James Coyne, BS*	Asiah Mohsen Elmasry, BS
Georgia Linwood Carter, BS**	Syiane Elizabeth Creamer, BS* <i>Magna Cum Laude</i>	Phillip John Elmer, BS
Jenna Elise Caswell, BS <i>Kappa Delta Pi</i>	Katherine Angela Cross, BS	Kyle Francis English, BS
Melissa Allison Catsam, BS	Brittany Anne Croteau, BS <i>Magna Cum Laude</i> <i>Eta Sigma Gamma</i> <i>Nat Soc Collegiate Scholar</i>	Natasha Grace English, BS <i>Cum Laude</i> <i>Nat Soc Collegiate Scholar</i>
Stefan Franco Cavezzali, BS <i>Summa Cum Laude</i> <i>Nat Soc Collegiate Scholar</i>	Dustina Marie Cunan, BS <i>Cum Laude</i> <i>Kappa Delta Pi</i> <i>Alpha Kappa Delta</i>	Kevin Michael Enright, BS*
Bonnie Mae Chalmers, BS, BA <i>Summa Cum Laude</i> <i>Kappa Delta Pi</i>	Nicole Elaine Curry, BS** <i>Phi Epsilon Kappa</i>	Jacquelyn Rose Ethier, BS** <i>Summa Cum Laude</i>
Shawn Paul Chamberlin, BS	Tyler Frederick Dabrowski, BS*	Jenna Lynn Fanelli, BS <i>Magna Cum Laude</i> <i>Phi Epsilon Kappa</i> <i>Nat Soc Collegiate Scholar</i>
		Jacob Anthony Farina, BS** <i>Cum Laude</i>
		Allan Marsh Faxon, III, BS
		Eric Thomas Fazio, BS

---

COMMENCEMENT 2013

---

Caitlin Diane Fecteau, BS <i>Summa Cum Laude</i> <i>Kappa Mu Epsilon</i> <i>Nat Soc Collegiate Scholar</i>	Ryan Charles Glick, BS <i>Magna Cum Laude</i> <i>Nat Soc Collegiate Scholar</i>	Alyssa Beth Hewitt, BS, BA <i>Nat Soc Collegiate Scholar</i>
Christopher Raymond Feyre, BS	Rachael Rose Gobeil, BS	Samantha Catherine Hibbert, BS <i>Phi Epsilon Kappa</i>
Kaitlin Laney Filipek, BS, BA <i>Magna Cum Laude</i> <i>Nat Soc Collegiate Scholar</i>	Evan Brent Godlewski, BS	Abigail Storer Higgins, BS* <i>Cum Laude</i> <i>Eta Sigma Gamma</i> <i>Nat Soc Collegiate Scholar</i>
Jamie Lee Finch, BS, BA** <i>Cum Laude</i> <i>Nat Soc Collegiate Scholar</i>	Taylor Lewis Goodwin, BS <i>Magna Cum Laude</i>	Jocelyn Ashlee Hill, BS <i>Magna Cum Laude</i>
Jessica Lynne Fiorenza, BS <i>Cum Laude</i> <i>Nat Soc Collegiate Scholar</i> <i>Rho Sigma Kappa</i>	Matina Rae Goulakos, BS, BA <i>Cum Laude</i>	Elizabeth Logue Hiney, BS <i>Eta Sigma Gamma</i> <i>Nat Soc Collegiate Scholar</i>
Brianna Marie Fisher, BS <i>Nat Soc Collegiate Scholar</i>	Matthew Michael Gould, BS	Elizabeth Louise Hoag, BS, BA
Kelsey Marie Fletcher, BS <i>Cum Laude</i> <i>Eta Sigma Gamma</i>	Jill Lynn Gourley, BS <i>Magna Cum Laude</i> <i>Nat Soc Collegiate Scholar</i>	Jessica Lauren Hoh, BS
Hilary Anne Flynn, BS	Alexander Patrick Greczylo, BS** <i>Rho Sigma Kappa</i>	Deanna Rose Hoke, BS, BA
Alyssa Marie Folsom, BS	Matthew Michael Greene, BS	Nicole Lee Holt, BS**
Emily Louise Fosnock, BS	Danielle Marie Griffin, BS, BA <i>Nat Soc Collegiate Scholar</i>	Mia Paige Hulslander, BS <i>Magna Cum Laude</i> <i>Eta Sigma Gamma</i>
Elizabeth Erin Fossum, BS	Chelsea Lynn Griswold, BS	Antonino James Hunter, BS
Alexandria Irena Fournier, BS <i>Magna Cum Laude</i> <i>Nat Soc Collegiate Scholar</i>	Colleen Marie Guckian, BS	Allison Marie Hutchins, BS
Katherine R.E. Foyle, BS, BA** <i>Magna Cum Laude</i>	Craig Gurley, BS	Spencer Alan Hutchinson, BS
Jamie Beth Fralick, BS	Prince T. Gweh, BS	Miranda Marie Ignoto, BS** <i>Kappa Delta Pi</i>
Megan Everne Frazier, BS	Laura Jeanne Hagan, BS*	Preston C. Ingram, BS** <i>Phi Epsilon Kappa</i> <i>Nat Soc Collegiate Scholar</i>
Gregg J. French, BS, BA <i>Cum Laude</i>	Joan Etta Hamel, BS	Jessica Grace Jahne, BS, BA <i>Kappa Delta Pi</i>
Kyle Daniel Frey, BS	Courtney Elizabeth Hamlin, BS, BA**	Tyler Andrew Jeffery, BS* <i>Cum Laude</i> <i>Rho Sigma Kappa</i>
Travis Freeman Fuglestad, BS <i>Rho Sigma Kappa</i>	Alison Kaleigh Hammell, BS, BA <i>Magna Cum Laude</i> <i>Nat Soc Collegiate Scholar</i>	Taylor G. Jette, BS*
Robert Lawrence Fuller, BS	Jeffrey James Harding, BS	Jessica Ashley Jodoin, BS <i>Magna Cum Laude</i> <i>Eta Sigma Gamma</i> <i>Nat Soc Collegiate Scholar</i>
Chantyl Marie Gable, BS <i>Rho Sigma Kappa</i>	Michael John Harrington, BS <i>Cum Laude</i>	Jay W. Johns III, BS
Lisa Eve Gaidosz, BS <i>Cum Laude</i> <i>Nat Soc Collegiate Scholar</i>	Austin Noel Harris, BS <i>Summa Cum Laude</i>	Elise Marie Johnson, BS, BA <i>Magna Cum Laude</i> <i>Nat Soc Collegiate Scholar</i>
Colin Terrence Gallagher, BS	Ian Howard Hart, BS	Ryan Adam Juneau, BS <i>Cum Laude</i> <i>Rho Sigma Kappa</i>
James Thomas Galloway, BS, BA**	Peter Henry Hartz, BS	Michelle Lynn Kendall, BS
Robert Scott Gaudet, BS	Parker Mason Hayes, BS	Shawn Kennedy, BS <i>Nat Soc Collegiate Scholar</i>
James Michael Geraghty, BS	Kirstin Hayes-Hand, BS <i>Cum Laude</i> <i>Eta Sigma Gamma</i>	Claire Jennie Keville, BS
Jenna Nicole Gibbons, BS	Michael Joseph Hebert, BS	Perry Kristopher Paul Killam, BS <i>Pi Delta Phi</i>
Mattison Jo Giroux, BS <i>Cum Laude</i> <i>Nat Soc Collegiate Scholar</i>	Katherine Anne Hedstrom, BS	
	Sara Jessica Heffernan, BS <i>Cum Laude</i> <i>Eta Sigma Gamma</i>	
	Michael Daniel Helmer, BS <i>Summa Cum Laude</i>	
	David Fritz Stephen Henning, BS <i>Cum Laude</i>	
	Curtis Brooks Herold, BS	

---

\* Expected to meet graduation requirements in September 2013

COMMENCEMENT 2013

Laura Jean Kolodziej, BS <i>Magna Cum Laude</i>	Shannon Marie Lombard, BS Leah Kay Lopes, BS** <i>Psi Chi</i>	Sarah Jeanne Merrifield, BS <i>Cum Laude</i> <i>Kappa Delta Pi</i> <i>Nat Soc Collegiate Scholar</i>
Nicole Marie Kondash, BS <i>Cum Laude</i> <i>Eta Sigma Gamma</i> <i>Nat Soc Collegiate Scholar</i>	Emily Rose Luckman, BS Karl Eric Ludwig, BS** Heather M. Luhrs, BS <i>Rho Sigma Kappa</i>	Rachel Lauren Messersmith, BS, BFA <i>Cum Laude</i> <i>Nat Soc Collegiate Scholar</i>
Jaynee Lea Krzywicki, BS April Kathleen Labbe, BS Christina Grace LaFauci, BS Kerri A. Lafond, BS <i>Magna Cum Laude</i>	Mallorie Judith Lyford, BS <i>Magna Cum Laude</i> <i>Eta Sigma Gamma</i>	Yoko Mikami, BS <i>Eta Sigma Gamma</i>
Leann Lam, BS Alicia Marie Lambert, BS Jessica Averie Lambert, BS <i>Cum Laude</i> <i>Eta Sigma Gamma</i>	Christopher Curtice MacDonald, BS Gabriella Katalin Magyar, BS Erica Theresa Mancino, BS <i>Eta Sigma Gamma</i>	Jason Kyle Miller, BS Allison Mary Miner, BS <i>Cum Laude</i> <i>Eta Sigma Gamma</i>
Danielle Lauren Lamontagne, BS Brian David Laplume, BS* Gabriel Francis LaPlume, BS <i>Summa Cum Laude</i>	Anthony Joseph Mariano, BS Jamie Michael Martin, BS Ryan Scott Martin, BS Kristy Ann Mastropietro, BS <i>Summa Cum Laude</i> <i>Nat Soc Collegiate Scholar</i>	Robert M. Mitchell, BS Cory Gregory Mollomo, BS <i>Rho Sigma Kappa</i> Thomas S. Morris, BS <i>Magna Cum Laude</i>
Corinne S. Larson, BS <i>Eta Sigma Gamma</i>	Lucas Anthony Mathews, BS <i>Magna Cum Laude</i>	Stephanie Ashley Morrison, BS <i>Magna Cum Laude</i> <i>Kappa Delta Pi</i>
Kyle James Lasher, BS Katherine Alyse Laskey, BS <i>Cum Laude</i> <i>Nat Soc Collegiate Scholar</i>	Hayley Marie Mattson, BS* Kayla Marie Matuszewski, BS <i>Magna Cum Laude</i> <i>Eta Sigma Gamma</i>	Nicholas Bradley Morse, BS** Zachary R. Morse, BS Anthony John Mucciario, BS Raven Grace Mueller, BS <i>Summa Cum Laude</i>
Matthew Malcolm Lavigne, BS <i>Cum Laude</i>	Nicole Marie Mayotte, BS William Joseph McAlister, BS <i>Cum Laude</i> <i>Rho Sigma Kappa</i> <i>Nat Soc Collegiate Scholar</i>	Emily Jane Murphy, BS* <i>Eta Sigma Gamma</i>
Cady Anne Lavoie, BS** Rebecca Leigh Lazinsk, BS* <i>Cum Laude</i> <i>Keene State Honors Program</i> <i>Nat Soc Collegiate Scholar</i>	Shea Michael McCarthy, BS Emily Marie McCormack, BS, BA Alexandra Michelle McCusker, BS Mekahla Claire McDonnell, BS Mia Dorothy McGorry, BS <i>Phi Epsilon Kappa</i>	Jenna Lee Nadeau, BS** Kelsey Bryn Nadeau, BS, AS Michael James Nallan, BS Christopher Michael Naples, BS Justin Carl Naquin, BS** Jarrett Bryce Navedo, BS Lucas Carl Neverisky, BS*
Emileigh S. Liebetrueth, BS <i>Summa Cum Laude</i> <i>Eta Sigma Gamma</i> <i>Nat Soc Collegiate Scholar</i>	Olivia Susan McGrath, BS <i>Cum Laude</i> <i>Upsilon Zeta</i> <i>Nat Soc Collegiate Scholar</i>	Adam James Nicastro, BS Gregory William Nickerson, BS** Carolyn Margueritte Noyes, AS Sarah Danielle Oakley, BS, BA Reed Frederick O'Brien, BS Julia Ann O'Connell, BS
Melody Jeanne Lindner, BS <i>Magna Cum Laude</i>	Lindsay Erin McManus, BS** <i>Cum Laude</i> <i>Phi Epsilon Kappa</i> <i>Nat Soc Collegiate Scholar</i>	Stephanie Thea O'Donnell, BS, BA <i>Magna Cum Laude</i> <i>Kappa Delta Pi</i> <i>Nat Soc Collegiate Scholar</i>
Danielle Juliette Lisella, BS* Jennifer Ann Little, BS <i>Magna Cum Laude</i> <i>Phi Epsilon Kappa</i>	Kevin Michael McNair, BS <i>Cum Laude</i> <i>Nat Soc Collegiate Scholar</i>	Megan Anne Olsen, BS** Eric Vincent Ostroski, BS Hallie Beth Ouellette, BS, BA**
Kaleigh Anne Liupakka, BS, BA <i>Cum Laude</i> <i>Kappa Delta Pi</i>	Evan Anthony McNamara, BS** Kellee Lauren McNeill, BS	Marissa Renee Ouellette, BS <i>Magna Cum Laude</i> <i>Kappa Delta Pi</i> <i>Nat Soc Collegiate Scholar</i>
Joleen Ann Lizotte, BS Christopher Paul Lockett, BS		

\*\* Expected to meet graduation requirements in December 2013

---

COMMENCEMENT 2013

---

Thomas Lee Paquette, BS	Kevin Hyacinth Provost, BS	Alyssa Shorrock, BS
Katelyn Helen Parmenter, BS	<i>Magna Cum Laude</i>	Adam Tristan D'Alessio Sidelinger, BS
<i>Cum Laude</i>	Joseph Andrew Purdon, BS*	<i>Magna Cum Laude</i>
<i>Eta Sigma Gamma</i>	Katelyn Marie Purrington, BS**	<i>Rho Sigma Kappa</i>
<i>Nat Soc Collegiate Scholar</i>	<i>Magna Cum Laude</i>	Kenneth Richard Sikes, BS*
Jenna Kathleen Parry, BS	<i>Kappa Delta Pi</i>	<i>Eta Sigma Gamma</i>
<i>Cum Laude</i>	<i>Nat Soc Collegiate Scholar</i>	<i>Upsilon Zeta</i>
Addy Elizabeth Parsons, BS**	Katelyn Lynn Quiet, BS	Jeffrey R. Slark, BS
Nicholas Alexander Paternoster, BS	James Matthew Radder, BS	Zachary Walter Slem, BS
Emily Beatrice Pelletier, BS, BA**	<i>Cum Laude</i>	Derek Mitchell Small, BS
Tyler John Penn, BS*	<i>Rho Sigma Kappa</i>	<i>Magna Cum Laude</i>
Benjamin David Perkins, BS	Allison Marie Ray, BS	<i>Nat Soc Collegiate Scholar</i>
Matthew Paul Perras, BS	Nicole Margaret Read, BS	Christine Michelle Smigel, BS
<i>Rho Sigma Kappa</i>	Jenna Elizabeth Recko, BS	Carolyn Anne Snide, BS
Samantha Mary Person, BS	Tyler Stephen Redes, BS	<i>Cum Laude</i>
<i>Phi Epsilon Kappa</i>	William Patrick Ries, BS**	Lindsay Beth Sookram, BS, BA
<i>Nat Soc Collegiate Scholar</i>	Rebecca Shaw Roberts, BS	<i>Summa Cum Laude</i>
Helena Emily Peters, BS	<i>Pi Delta Phi</i>	<i>Nat Soc Collegiate Scholar</i>
David James Peterson, BS*	David Michael Robicheau, BS	Deborah Barr Starratt, BS
Kyle Joseph Peterson, BS	Kevin Michael Robinson, BS	<i>Summa Cum Laude</i>
Alexandra Marie Petrilli, BS, BA	Stephan A. Rolfe, BS	Sarah Michele Stearns, BS
<i>Magna Cum Laude</i>	Ethan Andrew Romanelli, BS	Ryan Jay Steele, BS
<i>Nat Soc Collegiate Scholar</i>	Evan Daniel Ross, BS	<i>Magna Cum Laude</i>
<i>Kappa Mu Epsilon</i>	Patricia A. Ross, BS**	<i>Rho Sigma Kappa</i>
Andrew James Phillips, BS*	Jacquelyn Ashley Rougier, BS	<i>Nat Soc Collegiate Scholar</i>
Michael Stephen Piekielek, BS	Caitlin Marie Ruth, BS**	Maxwell Frederick Steinbrick, BS
<i>Cum Laude</i>	<i>Cum Laude</i>	Nicholas Andrew Steinbrick, BS
Alyssa Laura Pierce, BS	<i>Eta Sigma Gamma</i>	Cassandra Danielle Stuart, BS
<i>Cum Laude</i>	Shannon Lee Salinger, BS	Holly Joy Sullivan, BS
Kenneth Francis Pinkerton, BS*	<i>Cum Laude</i>	<i>Cum Laude</i>
Danielle Elaine Piper, BS	David A. Sampson Jr., BS, BA	Patrick Michael Sullivan, BS
<i>Magna Cum Laude</i>	Laura Briann Sanborn, BS	<i>Cum Laude</i>
Daniel Paul Uscilla Piscottano, BS**	<i>Cum Laude</i>	<i>Rho Sigma Kappa</i>
<i>Magna Cum Laude</i>	<i>Nat Soc Collegiate Scholar</i>	<i>Nat Soc Collegiate Scholar</i>
<i>Nat Soc Collegiate Scholar</i>	Lisa Catherine Sander, BS	Alex Duane Sunderland, BS
Shannon Elizabeth Poirier, BS	<i>Summa Cum Laude</i>	Rebecca Lynne Sweeney, BS**
<i>Cum Laude</i>	<i>Kappa Delta Pi</i>	Tegan Lee Swift, BS
<i>Kappa Delta Pi</i>	<i>Nat Soc Collegiate Scholar</i>	<i>Magna Cum Laude</i>
<i>Nat Soc Collegiate Scholar</i>	Katherine Marie Sasso, BS	<i>Eta Sigma Gamma</i>
Rebecca Lynn Polzella, BS	Natalie Eve Savas, BS	<i>Nat Soc Collegiate Scholar</i>
<i>Cum Laude</i>	<i>Cum Laude</i>	Allison Kate Tamiso, BS
<i>Eta Sigma Gamma</i>	<i>Nat Soc Collegiate Scholar</i>	<i>Cum Laude</i>
Derek Jon Pompea, BS	Elena Savidis, BS	<i>Phi Epsilon Kappa</i>
Joseph Charles Pratte, BS, BA	Melanie Jean Seavey, BS	<i>Nat Soc Collegiate Scholar</i>
<i>Cum Laude</i>	Joseph Blaine Senecal, BS	Courtney Lee Taylor, BS, BA
Jessica Jane Prevost, BS**	Julia Leigh Shea, BS	Kassandra Lynn Tenney, BS
<i>Cum Laude</i>	<i>Magna Cum Laude</i>	<i>Nat Soc Collegiate Scholar</i>
<i>Nat Soc Collegiate Scholar</i>	Kevin Daniel Sheridan, BS	Justin Robert Terrasi, BS*
Margarita Proulx, BS**	Matthew Harris Shinske, BS	<i>Cum Laude</i>
<i>Summa Cum Laude</i>	<i>Rho Sigma Kappa</i>	Evan Scott Thompson, BS
	<i>Nat Soc Collegiate Scholar</i>	James Francis Tieso, BS

---

COMMENCEMENT 2013

---

Jillian Mary Tomaselli, BS  
*Magna Cum Laude*  
*Keene State Honors Program*  
*Nat Soc Collegiate Scholar*  
 Michael Victor Trask, BS  
 Ryan Andrew Ullrich, BS  
 Kaila Jeanne Umbarger, BS  
*Nat Soc Collegiate Scholar*  
 Danielle Grace Vachon, BS  
 Angela Nicole Vita, BS  
 Jessica Lynne Wall, BS  
 William Anthony Wallace, BS\*\*  
 Frank Emanuel Wallack, BS  
 Jane Elise Walsh, BS  
 Kelsey L. Walsh, BS\*\*  
 Robert James Walsh, BS  
 Elisha Wamsley, BS

Mathew John Warner, BS  
*Cum Laude*  
*Nat Soc Collegiate Scholar*  
 Ian Michael Watters, BS  
*Cum Laude*  
*Eta Sigma Gamma*  
*Upsilon Zeta*  
 Sarah Ann Weaver, BS  
*Kappa Delta Pi*  
 Allison Mae Weber, BS  
*Cum Laude*  
*Kappa Delta Pi*  
 Kellie Ann Weber, BS  
*Zeta Chi Rho*  
 Jessica Marie Webster, BS  
 Jennifer Lynn Welch, BS\*

Jonathan Peter Westphal, BS  
*Cum Laude*  
 Jesse George Wilcox, BS\*\*  
 Candice Nicole Wilke, BS  
 Ali Marie Williams, BS  
*Rho Sigma Kappa*  
 Geoffrey Ezekiel Woodberry, BS  
 Alicia Jewell Woodruff, BS\*\*  
 Tiffany Gayle Woodworth, BS  
*Magna Cum Laude*  
*Eta Sigma Gamma*  
*Nat Soc Collegiate Scholar*  
 Emily Hazel Wytas, BS  
*Magna Cum Laude*  
 Kristen Marie Zaleski, BS\*\*  
*Cum Laude*  
 Carolyn Grace Zuccaro, BS\*\*

## Graduate Studies

---

Kate Adams Shanks, MEd  
 Timothy D. Ainsworth, MS\*\*  
 Chantelle L. Albin, MEd  
 Holly Heden Amato, MEd\*  
 Nicole Aleece Antonelli, MEd  
 Keri Ellen Arsenaault, MEd  
 Ellen Marie Banning, MEd\*  
 Joshua Aaron Besnoff, MS\*  
 Laurie Beth Bolotin, MEd  
 Samantha Ann Burr, MEd  
 Eric Michael Cafazzo, MS\*  
 Caitlin M. Campbell, MEd  
 Alyssa Mary Collyer, MEd  
 Lauren Mary Dagrosa, MEd  
 Brianne Marie Dassatti, MEd  
 Amy Anne Decarolis, MEd  
 Kim Helfer Ditullio, MEd\*  
 Jodie Rae Dresser, MEd  
 Haley Elizabeth Duncan, MEd

Kaitlyn Ellis, MEd  
 Leonard Thomas Evers, MS  
 Robin L. Fairfield, MEd  
 Anne Keefe Farley, MEd  
 Gustaf Bernhard Friberg II, MEd\*  
 Laura Friel, MEd  
 Michelle Gilman, MEd\*  
 Kellie Ann Gouin, MEd  
 Jessica Newberry Grant, MEd  
 Michelle E. Guardiani, MEd  
 Karen Marie Gutierrez, MEd\*  
 Joanne Christine Hamor, MEd  
 Ryan Hannan, MS\*  
 Lauren Michele Hannum, MEd\*  
 Corey Joseph Hartson, MS\*  
 Felicia Jean Harvey, MEd  
 Mary Katherine Head, MEd  
 Matthew A. Hitchcock, MS\*  
*Rho Sigma Kappa*

Maryann Kinney, MEd\*  
 Laurel Anne Martin-Brandley, MEd  
 Sara Ashley Marzinzik, MEd\*  
 Samantha Josephine Massahos, MEd\*  
 Kelsey Mulcahy, MEd  
 Jeffrey Oliver Pelkey, MS\*  
 Denise Marie Davila Presutti, MEd\*  
 John Michael Raiola, Jr, MEd\*  
 Jenna L. Richards, MEd  
 Rebecca Mary Richmond, MEd  
 Chelsey N. Rothermel, MEd  
 Edward S. Tokarski, MS  
 Kimberly Helen Welcher, MEd  
 Caitlin Ann Duffy Wright, MEd\*  
 Kathryn A Wright, MEd\*  
 Aleisha Faye Zawadski, MEd

## The Academic Procession

The academic procession is derived from European religious processions of the 12th and 13th centuries, when universities were forming but were still closely associated with the medieval church. The procession is comprised of members of the Keene State faculty and administrative staff, in order of length of service, with those with the longest tenure appearing first. This group is followed by members of today's platform party. The final two participants to move onto the stage will be mace bearer Carl R. Granquist, professor of history, and Interim President Jay Kahn.

## The Mace

The word *mace* is derived from the Latin *mateola*, meaning mallet or staff. In the Middle Ages, these staffs, with a ball of copper or brass at one end, were used as weapons against armored warriors. As weaponry became more sophisticated, the mace evolved as a symbol of power. Universities in Europe adopted the mace as a symbol of authority and unity, and today many institutions use the mace in a ceremonial capacity. A new Keene State College mace was presented to President Yarosewick by the KSC Alumni Association at his inauguration in 1995. Fashioned of black walnut and brass, the mace was made by Charles Sheaff, a member of the class of 1972 and professor of industrial technology. The mace is carried to official College functions by the senior faculty member in length of service to the College.

## Gonfalons

Gonfalons are the flags that lead the procession of candidates into Commencement. Each gonfalon contains the Keene State College seal and the name of the school it represents: Arts and Humanities, Professional and Graduate Studies, and Sciences and Social Sciences. The primary colors in the banner represent Keene State College, and the colored trim represents the disciplines within the school. In the 12th century, gonfalons became the symbol of a state, family, or office. Since that time, they have become part of academic ceremonies, including commencements, convocations, and special events, such as the installation of a president.

---

## Academic Regalia

The caps, gowns, and hoods seen today evolved from European medieval costumes worn during religious processions to distinguish church and university members from the laity. Most medieval scholars had taken at least minor orders and, like clerics, wore long robes for warmth in unheated buildings.

Modern academic costume in the United States is based on an intercollegiate code established in 1895. Most gowns are black, although in recent years more American universities have allowed the use of their college colors. The hood, which drapes over the back of the gown, carries the greatest symbolism of all the components of the academic costume. It dates back to the 12th century, when it functioned as a head cover and shoulder cape. The hood lining, which is exposed in the center as it lies over the back of the gown, matches the color or colors of the degree-granting institution, and the velvet trim on the hood reveals the wearer's major field of study. Those who hold more than one academic degree may wear only one hood at a time.

## Academic Honors Recognition

Students graduating with honors from Keene State College enter the Commencement Ceremony wearing gold tassels. The tassels, awarded for outstanding academic accomplishment, are presented to the students at the Spring Honors Convocation on Friday afternoon.

## International Sashes

Two groups of students wear international sashes during the Commencement Ceremony: international students and students who have participated in a Keene State College-sponsored study away program for credit. The sash represents the international student's country of origin or the host nation of the study away program.

## Honor Cords and Red Sashes

Some graduating seniors wear cords or sashes representing membership in an honor society. Red sashes may also indicate participation in a recognized student organization.

---

## The Recessional

Since the College's 75th anniversary year, the tradition of "clapping through" has been added to the Commencement recessional. Faculty and staff lead the recessional in two columns down the center aisle and out to Appian Way. The two rows turn and face each other, applauding as the graduates pass through. Clapping through allows the faculty and staff to congratulate the new degree recipients during the recessional. Graduates, faculty, staff, and families are then invited to the President's Reception at the Zorn Dining Commons and plaza.



MICHAEL MOORE

# Board of Trustees

## University System of New Hampshire

William F. J. Ardinger  
*Concord, 2008–2015*

Robert A. Baines  
*Manchester, 2011–2015*

Judith E. Blake  
*Portsmouth, 2008–2016*

Frederick C. Dey  
*Portland, Maine, 2011–2015*

Pamela Diamantis  
*Greenland, Vice Chair, 2008–2016*

Edward C. Dupont  
*Concord, 2003–2013*

George Epstein  
*Silver Lake, 2002–2014*

Richard E. Galway  
*Bedford, Chair, 2009–2013*

Kimberly I. Hallett  
*Granite State College, Student  
Trustee, 2010–2013*

Elizabeth K. Hoadley  
*Concord, Secretary, 2006–2014*

Chester E. Homer III  
*Portsmouth, 2008–2016*

Kenneth C. Moulton  
*Bow, 2012–2015*

Alexander C. Nix  
*Plymouth State University, Student  
Trustee, 2012–2013*

Carol S. Perkins  
*Plymouth, 2008–2013*

Timothy M. Riley  
*Bedford, 2009–2013*

John W. Small  
*New Castle, 2010–2015*

Henry (Hank) B. Stebbins  
*Manchester, 2006–2016*

Wallace R. Stevens  
*Hampton Falls, 2011–2015*

**Ex Officio**

Virginia Barry  
*Commissioner of Education*

Jay V. Kahn  
*Interim President, Keene State College*

Mark W. Huddleston  
*President, University of  
New Hampshire*

Todd J. Leach  
*Interim Chancellor and President,  
Granite State College*

The Honorable Maggie Hassan  
*Governor, State of New Hampshire*

Lorraine S. Merrill  
*Commissioner, New Hampshire  
Department of Agriculture, Markets,  
and Food*

Sara Jayne Steen  
*President, Plymouth State University*

---



.....

Turn in found items or search for lost items during the Commencement Ceremony at the Information Table on Appian Way located on the back side of the quad. For items found/lost after the Commencement Ceremony contact Campus Safety.

# KEENE STATE COLLEGE EMERGENCY EVACUATION MAP

Please take note of the zone of your general seating area. In case of evacuation, please proceed in a safe and orderly fashion to the temporary refuge building corresponding to your seating area if you choose to seek shelter.

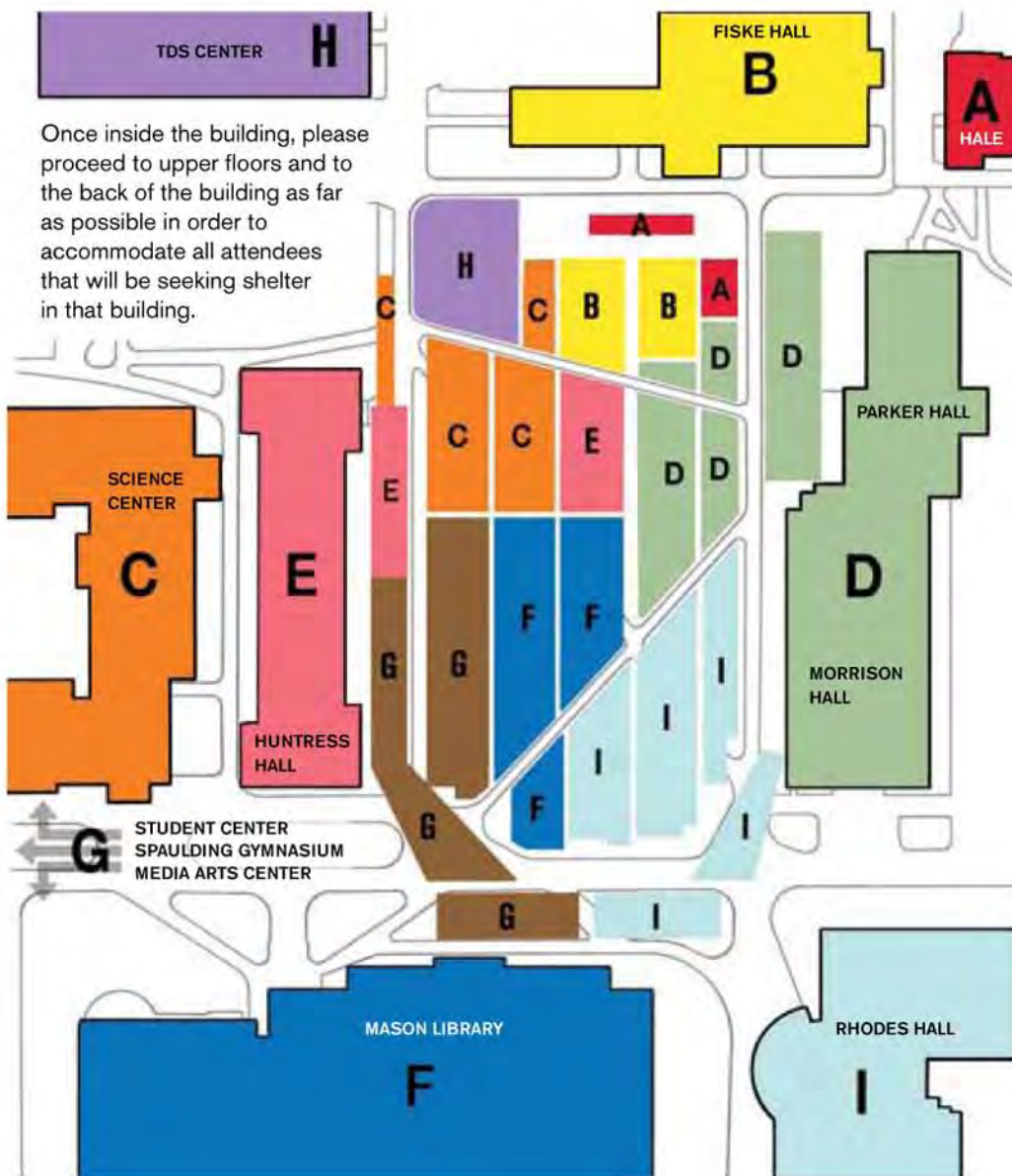

Once inside the building, please proceed to upper floors and to the back of the building as far as possible in order to accommodate all attendees that will be seeking shelter in that building.

